

THIS DRAWING IS UNPUBLISHED.  
 © COPYRIGHT BY TYCO ELECTRONICS CORPORATION. ALL RIGHTS RESERVED.

LOC CM O  
 DIST H  
 P LTR H  
 REVISIONS ECO-07-012887  
 DATE 22JUN07  
 DWN KW  
 APD DB

1 2 3 4

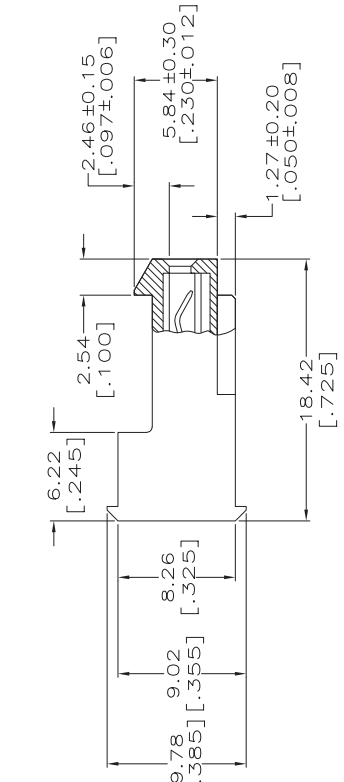
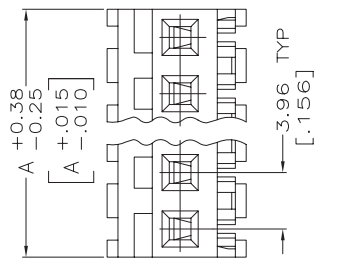
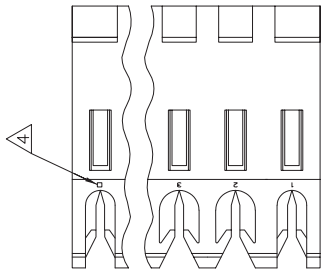

1. MATERIAL: NYLON UL94V-2 (BLUE).  
 CONTACTS - THICK COPPER ALLOY.  
 CONTACTS - 0.30[0.12] THICK COPPER ALLOY.  
 PLATING - 0.00038[0.00015] GOLD IN CONTACT AREA.  
 0.00203[0.00080] MIN THICKNESS BRIGHT  
 TIN-LEAD IN SLOT AREA FOR 641172-2  
 THRU 2-641172-4 OR MATTE WHISKER  
 MITIGATED TIN IN SLOT AREA FOR  
 3-641172-2 THRU 5-641172-4 OVER  
 NICKEL UNDERPLATE.

2. CONTACTS ACCEPT 26 AWG WIRE WITH 2.41[0.095] MAX INSULATION DIAMETER.
3. CONTACTS MUST ACCEPT 1.14±0.03[0.045±0.01] SQUARE POST AND REMAIN LOCKED IN POSITION.
4. IDENTIFICATION NUMBER FOR LAST CIRCUIT MAY NOT APPEAR ON ALL ASSEMBLIES.
5. DIMENSIONS IN BRACKETS ARE IN INCHES.
6. HOUSING FEATURES ARE: FEED-THRU WITH LOCKING RAMP.

NOTE DELETED.  
 NOTE DELETED.

95.10	3.744	24	5-641172-4
91.14	3.588	23	5-641172-3
87.17	3.432	22	5-641172-2
83.21	3.276	21	5-641172-1
79.25	3.120	20	5-641172-0
75.29	2.964	19	4-641172-9
71.32	2.808	18	4-641172-8
67.36	2.652	17	4-641172-7
63.40	2.496	16	4-641172-6
59.44	2.340	15	4-641172-5
55.47	2.184	14	4-641172-4
51.51	2.028	13	4-641172-3
47.55	1.872	12	4-641172-2
43.59	1.716	11	4-641172-1
39.62	1.560	10	4-641172-0
35.66	1.404	9	3-641172-9
31.70	1.248	8	3-641172-8
27.74	1.092	7	3-641172-7
23.77	0.936	6	3-641172-6
19.81	0.780	5	3-641172-5
15.85	0.624	4	3-641172-4
11.89	0.468	3	3-641172-3
7.92	0.312	2	3-641172-2
95.10	3.744	24	2-641172-4
91.14	3.588	23	2-641172-3
87.17	3.432	22	2-641172-2
83.21	3.276	21	2-641172-1
79.25	3.120	20	2-641172-0
75.29	2.964	19	1-641172-9
71.32	2.808	18	1-641172-8
67.36	2.652	17	1-641172-7
63.40	2.496	16	1-641172-6
59.44	2.340	15	1-641172-5
55.47	2.184	14	1-641172-4
51.51	2.028	13	1-641172-3
47.55	1.872	12	1-641172-2
43.59	1.716	11	1-641172-1
39.62	1.560	10	1-641172-0
35.66	1.404	9	641172-9
31.70	1.248	8	641172-8
27.74	1.092	7	641172-7
23.77	0.936	6	641172-6
19.81	0.780	5	641172-5
15.85	0.624	4	641172-4
11.89	0.468	3	641172-3
7.92	0.312	2	641172-2

THIS DRAWING IS A CONTROLLED DOCUMENT.  
 DWN B. LEWIS 3-11-98  
 CHK C. SWING 3-11-98  
 APD -  
 NAME Tyco Electronics  
 Tyco Electronics Corporation  
 Harrisburg, Pa 17105-3608

CONTRACT FINISH DIM A NO. OF CIRCUITS PART NO.  
 TIN-LEAD 47.55 1.872 12 1-641172-3  
 43.59 1.716 11 1-641172-1  
 39.62 1.560 10 1-641172-0  
 35.66 1.404 9 641172-9  
 31.70 1.248 8 641172-8  
 27.74 1.092 7 641172-7  
 23.77 0.936 6 641172-6  
 19.81 0.780 5 641172-5  
 15.85 0.624 4 641172-4  
 11.89 0.468 3 641172-3  
 7.92 0.312 2 641172-2

OTHER DIMENSIONS:  
 0 PLG ±  
 1 PLG ±  
 2 PLG ±  
 3 PLG ±  
 4 PLG ±  
 5 PLG ±  
 6 PLG ±  
 7 PLG ±  
 8 PLG ±  
 9 PLG ±  
 10 PLG ±  
 11 PLG ±  
 12 PLG ±  
 13 PLG ±  
 14 PLG ±  
 15 PLG ±  
 16 PLG ±  
 17 PLG ±  
 18 PLG ±  
 19 PLG ±  
 20 PLG ±  
 21 PLG ±  
 22 PLG ±  
 23 PLG ±  
 24 PLG ±

CONTRACT FINISH DIM A NO. OF CIRCUITS PART NO.  
 DIM A 47.55 1.872 12 1-641172-3  
 43.59 1.716 11 1-641172-1  
 39.62 1.560 10 1-641172-0  
 35.66 1.404 9 641172-9  
 31.70 1.248 8 641172-8  
 27.74 1.092 7 641172-7  
 23.77 0.936 6 641172-6  
 19.81 0.780 5 641172-5  
 15.85 0.624 4 641172-4  
 11.89 0.468 3 641172-3  
 7.92 0.312 2 641172-2

SCALE 4:1 SHEET 1 OF 1

MTA-156 CONNECTOR ASSEMBLY,  
 26 AWG, STANDARD

SIZE CASE CODE DRAWING NO  
 A2 00779 641172

CUSTOMER DRAWING

