



PANDUIT PART NUMBER	WEIGHT
FRRF126R	1.02 LB/EACH (462g/EACH)



NOTES:

1. SEE CURRENT CATALOG FOR ADDITIONAL PART SUFFIXES TO INDICATE COLOR AND/OR PACKAGE QUANTITY.
2. THE FIBERRUNNER 12x4 TRANSITION RIGHT WITH 6" EXIT IS DESIGNED WITH A MINIMUM 2" (50.8) BEND RADIUS TO PROTECT FIBER OPTIC CABLES.
3. DIMENSIONS IN PARENTHESES ARE IN METRIC.

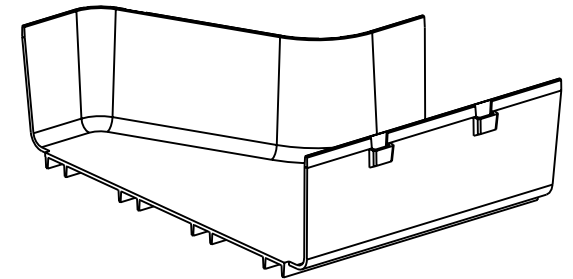
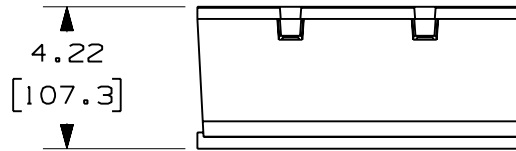
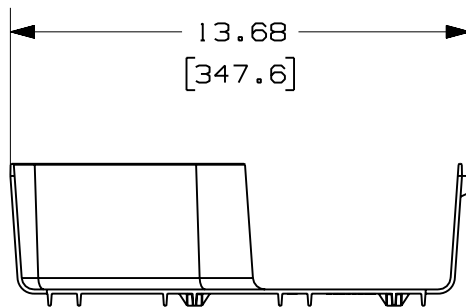
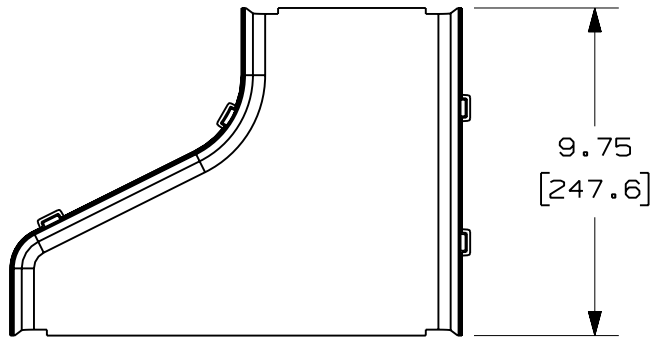

ENG. REF.: D37617XA_DC_FRRF126R_01.prt

CAD FILENAME/LAYERS

△ FRRF126R.pdf

PANDUIT CORP TINLEY PARK, ILLINOIS
**FIBERRUNNER 12x4 TRANSITION
 RIGHT WITH 6" EXIT (FRRF126R)**
△ CUSTOMER DRAWING

UNLESS OTHERWISE SPECIFIED,
 DIMENSIONAL TOLERANCES ARE:

(.X) ± (.XXX) ±
 (.XX) ± .03 (.8) ANGLES ±

UNLESS OTHERWISE SPECIFIED,
 ALL DIMENSIONS ARE GIVEN IN
 INCHES, THIRD ANGLE PROJECTION.

DRAWN BY
 JHNU

MAT'L:

DATE
 5-24-01

ABS

SCALE
 NONE

DRAWING NO.
 37617-113

DWG
 A
 SIZE

REV	DATE	BY	CHK	DESCRIPTION	ECN	R	CUST	SUP	GMBH
-	-----	---	---	E. REVISED PART WEIGHT	-----	--	--		
-	-----	---	---	D. REVISED GENERAL NOTES C. REVISED CAD FILENAME	-----	--	--		
1	7-13-06	DTP	RN	B. REVISED DRAWING TITLE A. REVISED AND REDRAWN	37617-113	RN	RN		

CHK'D
 HIW