



Amphenol
FCi



Copyright AFci



1

2

3

4

5

6

TECHNICAL SPECIFICATION

HOUSING MATERIAL : HIGH TEMPERATURE THERMOPLASTIC POLYESTER UL94V-0, NATURAL
HOUSING CAN WITHSTAND EXPOSURE TO 260°C PEAK TEMPERATURE FOR 30 SECONDS IN A CONVECTION, INFRARED OR VAPOUR REFLOW SOLDER APPLICATION

CONTACT / HARPOON MATERIAL : COPPER ALLOY
CONTACT ACTIVE ZONE PLATING : Au / GXT™ OVER NICKEL
CONTACT TERMINATION ZONE/HARPOON PLATING :
LEAD FREE VERSION : TIN (PURE MATTE) OVER Ni

ELECTRICAL DATA

CURRENT RATING AT 20°C : 1.5 A
CURRENT (I MAX) : 2 A
TEMPERATURE RANGE : -55°C/+125°C
CONTACT RESISTANCE : ≤ 20mΩ
INSULATION RESISTANCE : ≥ 10⁶ MΩ
TEST VOLTAGE (rms) : 1000V

MECHANICAL DATA

INSERTION FORCE PER CONTACT : ≤ 0.94N
EXTRACTION FORCE PER CONTACT : ≥ 0.15N

REFERENCE SPECIFICATIONS : DIN 41612 / IEC 603-2

SERIES	8609	3	48	8	3	14	B	5	5	F1LF
ROWS FITTED WITH CONTACTS										
Rows a-b-c		3	48							
Rows a-c		4	32							
NUMBER OF CONTACTS										
TYPE OF INSULATOR										
3 ROW FEMALE INSULATOR			8							
METHOD OF MOUNTING										
STANDARD MOUNTING STYLE- C/2						3				
TERMINATION										
STRAIGHT SPILL LONG, L = 4.0 (+0.7, -0)									14	
STRAIGHT SPILL SHORT, L = 2.5 (+0.7, -0)									24	
OPTIONS										
HIGH TEMPERATURE HOUSING (NATURAL)										B
HIGH TEMPERATURE HOUSING (NATURAL) WITH HARPOONS										T
PERFORMANCE CLASS										
4 - DIN 41612 CLASS 3										4
5 - DIN 41612 CLASS 2										5
6 - DIN 41612 CLASS 1										6
8 - AS PER MIL C 55302/JSS 50808										8
PITCH PER ROW										
2.54										5
F1LF										HIGH TEMPERATURE INSULATOR, LEAD FREE VERSION

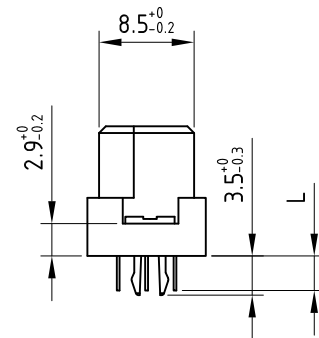
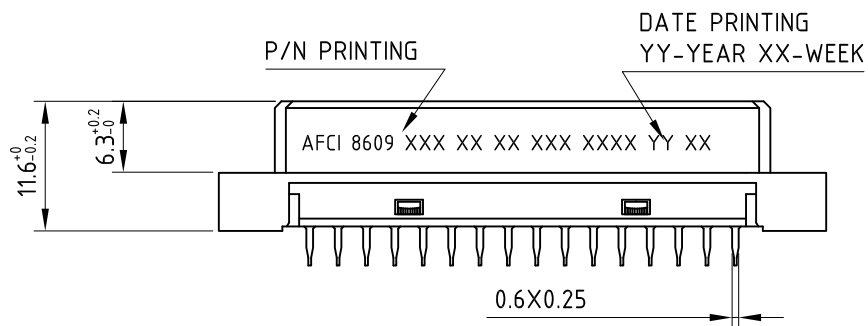
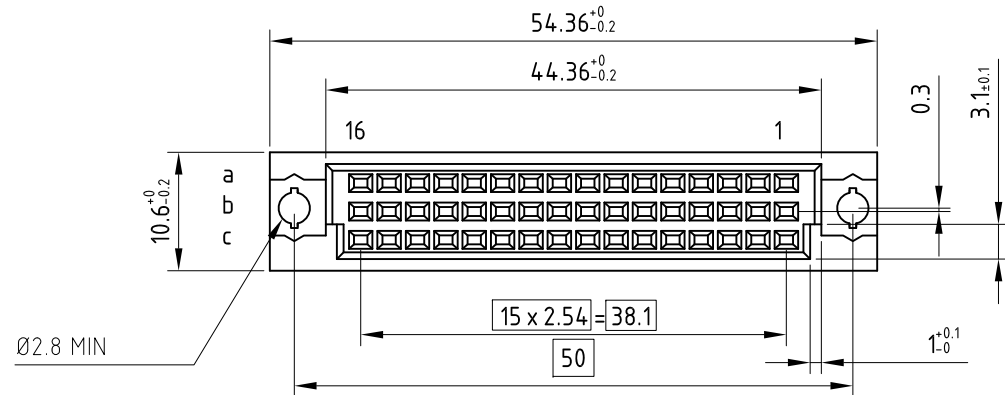

PCB LAYOUT

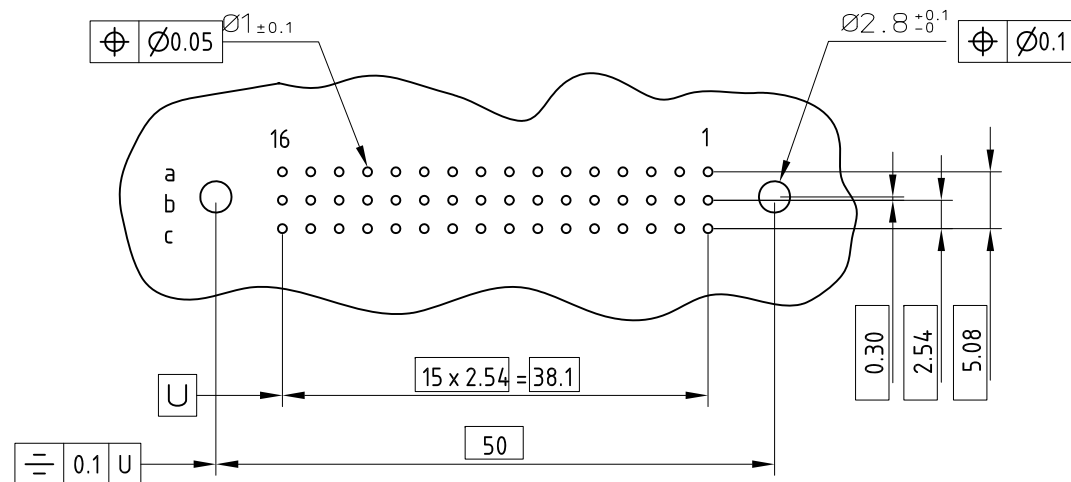

NOTES:

- THE "LF" PRODUCTS MEET EUROPEAN UNION DIRECTIVES AND OTHER COUNTRY REGULATIONS AS DESCRIBED IN GS-47-0004.
- LEAD FREE OR RoHS DIRECTIVE LABELING TO BE PROVIDED AS PER GS-14-920 FOR LEAD FREE VERSION.
- FOR GENERAL CHARACTERISTICS AND RoHS INFORMATION, REFER DRAWING C-8609-0000A.

mat'l. code		surface		tolerance		projection		product family	
SEE TECH SPEC		ISO 1302 ✓		ISO 406 ISO 1101				8609	
ltr		ecn no		date		tolerances unless otherwise specified		title	
A		-		MJA 2016-11-29		0.X ±0.1		DIN STANDARD RECEPTACLE	
-		-		-		linear		DIN 41612 STRAIGHT SPILL STYLE C/2	
-		-		-		0°±1°		(HIGH TEMPERATURE VERSION)	
-		-		-		scale 3:2		dwg no	
-		-		-		Amphenol FCI		sheet 1 of 1	
-		-		-		-		size	
-		-		-		-		C-8609-2365	
-		-		-		-		A3	
-		-		-		-		type Product Customer Drawing	
sheet index		revision sheet		A 1					